



T&S BRASS AND BRONZE WORKS, INC.

2 Saddleback Cove / P.O. Box 1088
Travelers Rest, SC 29690



REG. #A2601
ISO #9001

Model No.
B-0658

Item No.

Travelers Rest, SC: 800-476-4103 Simi Valley, CA: 800-423-0150 Fax: 864-834-3518 www.tsbrass.com

This Space for Architect/Engineer Approval

Job Name _____ Date _____

Model Specified _____ Quantity _____

Customer/Wholesaler _____

Contractor _____

Architect/Engineer _____

Support Rod Asm. Furnished w/
Wall Bracket and Mounting Screws



ADA Compliant

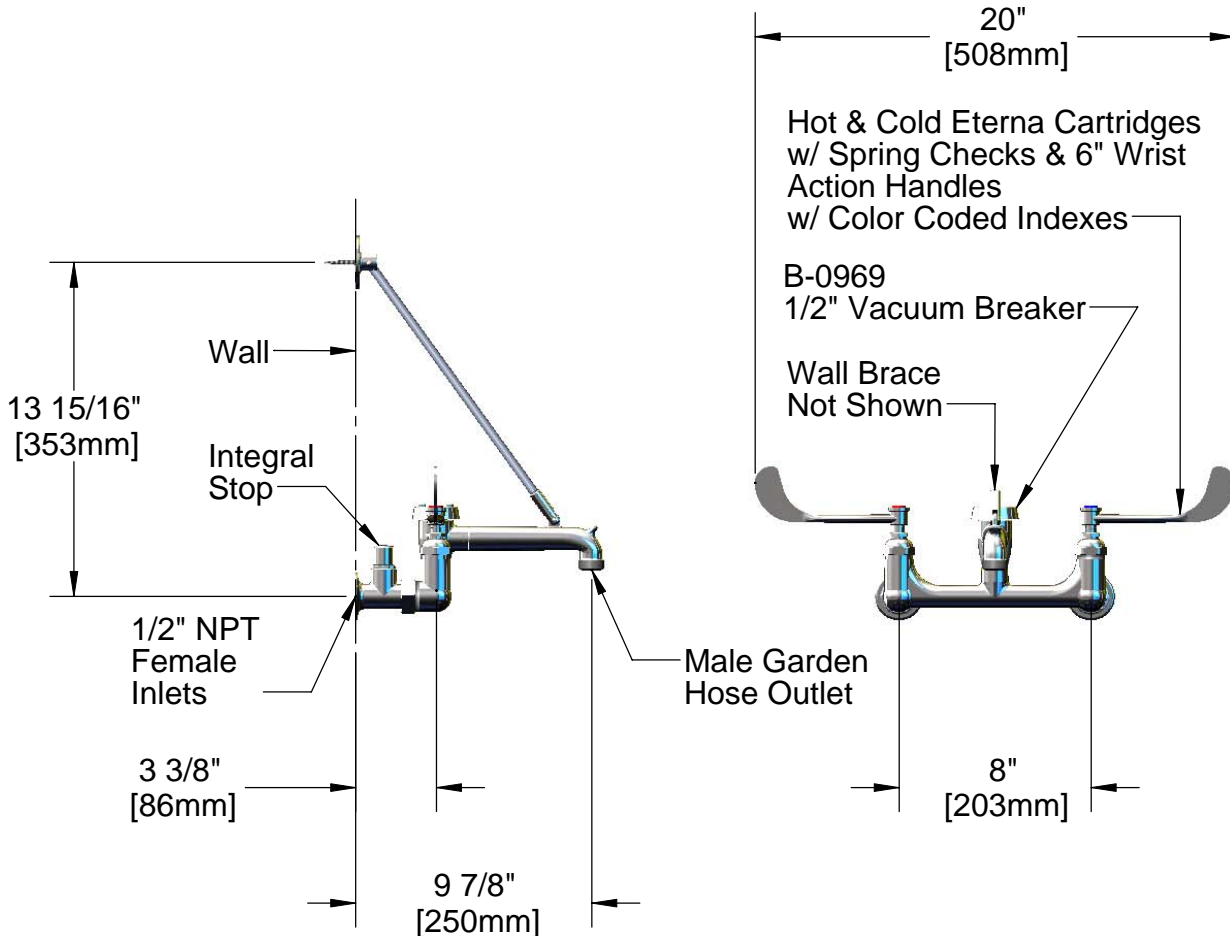

Product Specifications:

Service Sink Faucet, 6" Wrist Action Handles, Vacuum Breaker Outlet, Integral Stops, Wall Brace Assembly & 1/2" NPT Female Inlets

Drawn DHL	Checked GEF	Approved JHB
Scale: 1:8		Date: 5/16/08



T&S BRASS AND BRONZE WORKS, INC.

2 Saddleback Cove / P.O. Box 1088
Travelers Rest, SC 29690



REG. #A2601
ISO #9001

Model No.

B-0658

Item No.

Travelers Rest, SC: 800-476-4103 Simi Valley, CA: 800-423-0150 Fax: 864-834-3518 www.tsbrass.com

ITEM NO.	SALES NO.	DESCRIPTION
1	012443-40	Eterna w/ Spring Check Hot Spindle Assembly
2	B-0969	Vacuum Breaker, 1/2"
3	001194-45	Red HW Index
4	B-WH6	6" Wrist Action Handle
5	001686-45	Blue CW Index
6	000925-45	Lab Handle Screw
7	012442-40	Eterna w/ Spring Check Cold Spindle Assembly
8	001605-45	Cap
9	002892-40	Spindle Asm w/ Cap
10	000763-20	Seat
11	00JJ	Flange w/ Intergral Stop Asm. 1/2" NPT Female Inlet
12	001019-45	Coupling Nut Washer

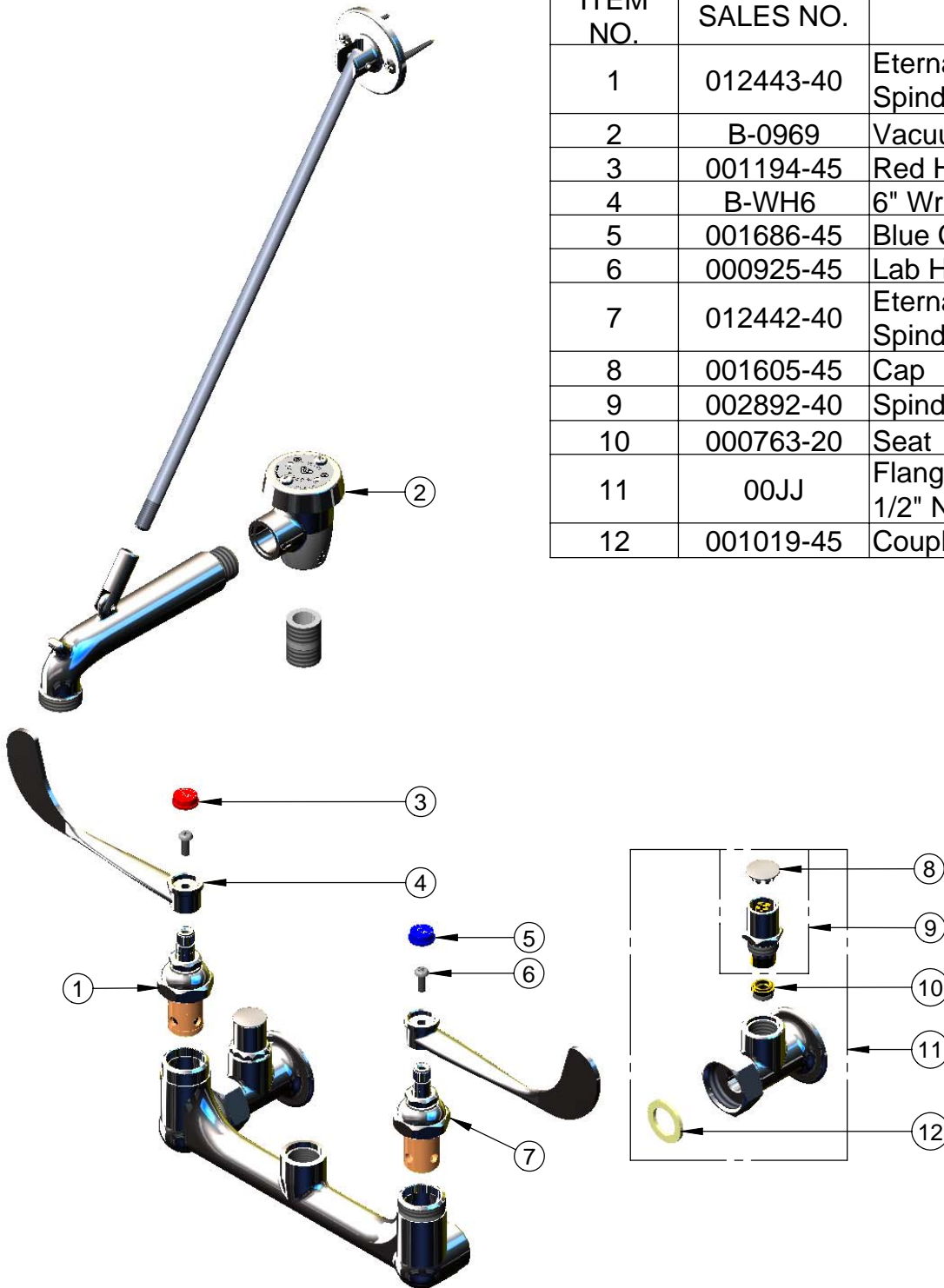

Product Specifications:

Service Sink Faucet, 6" Wrist Action Handles, Vacuum Breaker Outlet, Integral Stops, Wall Brace Assembly & 1/2" NPT Female Inlets

Drawn DHL	Checked GEF	Approved JHB
Scale: 1:4		Date: 5/16/08