

B-0665-RGH, B-0665-BSTR, B-0665-BSTP

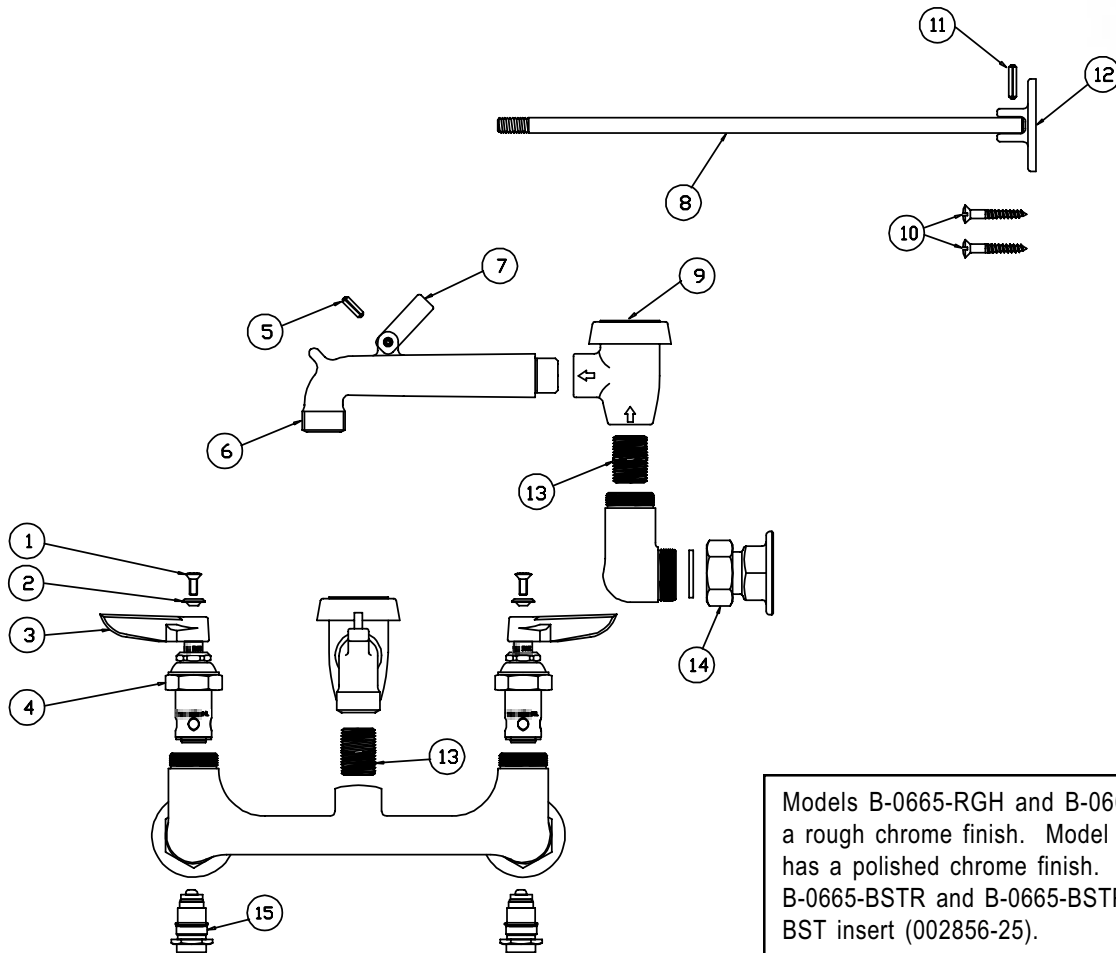

Models B-0665-RGH and B-0665-BSTR have a rough chrome finish. Model B-0665-BSTP has a polished chrome finish. Models B-0665-BSTR and B-0665-BSTP both include BST insert (002856-25).

Faucet Assembly

1	Screw, Handle	000922-45
2	Index, Button - Blue/Cold	001660-45
	Index, Button - Red/Hot	001661-45
3	Handle, Lever	001638-45
4	Asm, Spindle, Eterna - Cold	005959-40
	Asm, Spindle, Eterna - Hot	005960-40
5	Rollpin, Clevis	001311-45
6	Spout, Polished (B-0665-BSTP)	000188-40
	Spout, Rough (B-0665-RGH & B-0665-BSTR)	000188-25
7	Clevis	004713-25
8	Rod, Support	005060-40
9	Asm, Vacuum Breaker	B-0969
10	Screw, Wall Mount	000915-45
11	Rollpin, Support Rod	006211-45
12	Flange, Support Rod	003007-45
13	Nipple	002534-25
14	Asm, Coupling	00AA
15	Asm, BST Spindle and Insert (B-0665-BSTR & B-0665-BST)	002586-25

