

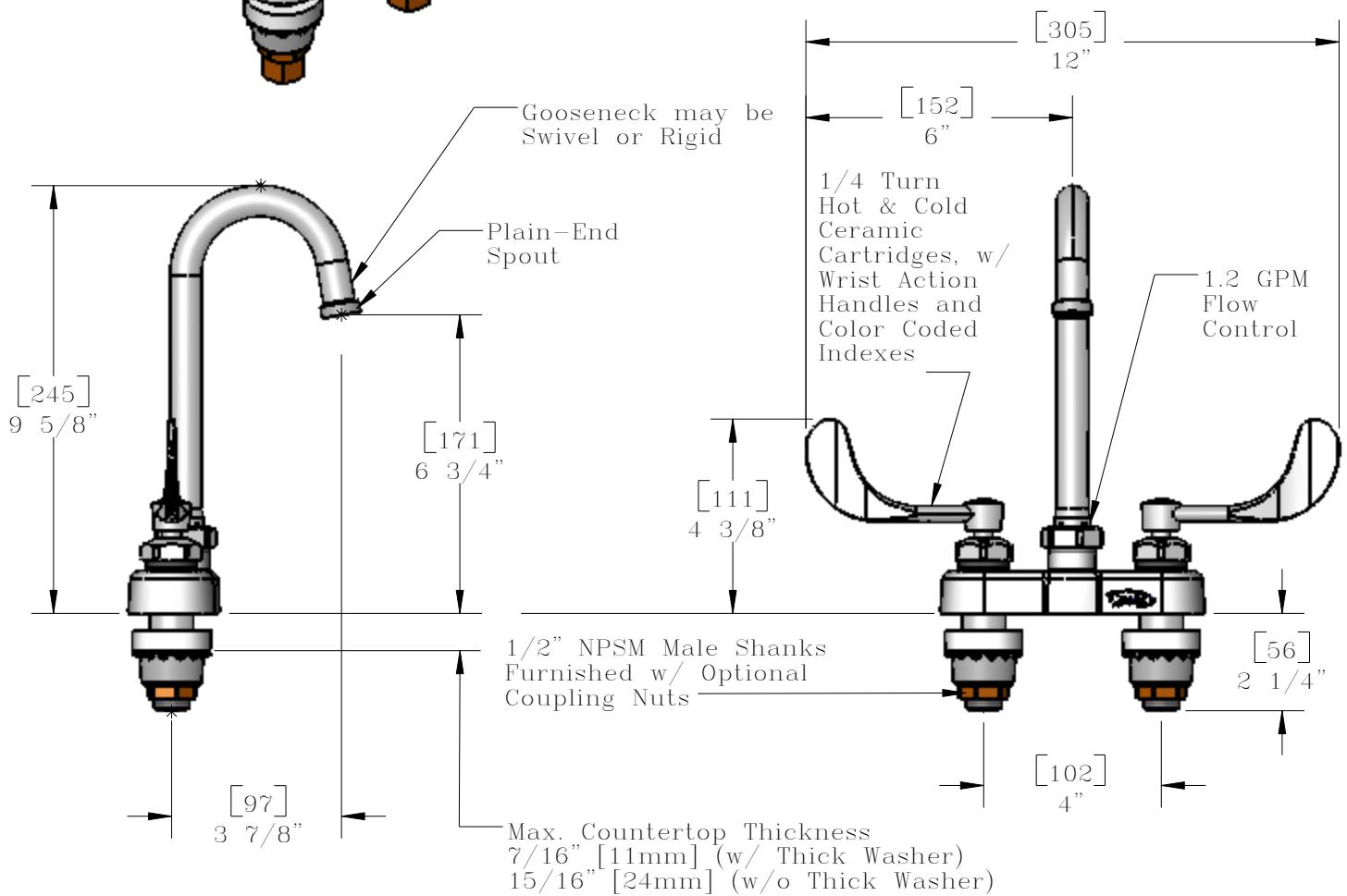

This Space for Architect/Engineer Approval

Job Name _____ Date _____
 Model Specified _____ Quantity _____
 Customer/Wholesaler _____
 Contractor _____
 Architect/Engineer _____

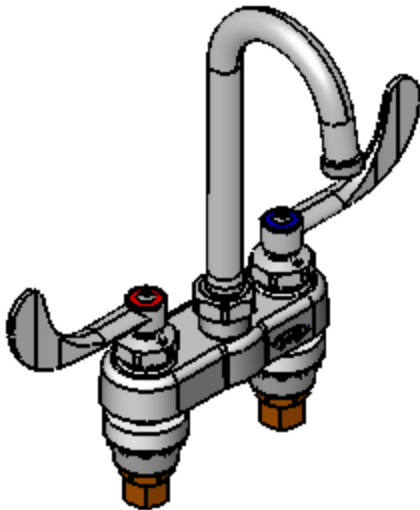

| | | | | | |
|----------------------------|-----------------|--------------|--------------|----------------|-----------------|
| Model Number Q-438WA-5W | Date 8/14/06 | Scale 1:4 | Drawn DHL | Checked JRM | Approved JHB |
|----------------------------|-----------------|--------------|--------------|----------------|-----------------|



Product Specifications:
 4" Centerset Mixing Faucet, Ceramic Cartridges,
 Wrist Action Handles, 3 1/2" Gooseneck (GN-A),
 1.2 GPM Flow Control



T&S BRASS AND BRONZE WORKS, INC.
 2 Saddleback Cove, P.O. Box 1088
 Travelers Rest, South Carolina 29690
 Phone: 800.476.4103 Fax: 800.834.3518, Simi Valley 800.423.0750



REG. #A2601
 ISO #9001

| ITEM NO. | SALES NO. | DESCRIPTION |
|----------|------------|--|
| 1 | Q015383-40 | Standard Ceramic Cartridge, Hot |
| 2 | Q015384-40 | Standard Ceramic Cartridge, Cold |
| 3 | Q015975-40 | Wrist Action Handle, 1-Pack Kit |
| 4 | Q015974-40 | Wrist Action Handle, 2-Pack Kit |
| 5 | Q016124-40 | 3 1/2" Gooseneck (GN-A) w/ 1.2 GPM Flow Control & Spout Ring |
| 6 | Q016062-45 | GN Swivel/Rigid Kit |
| 7 | Q015424-40 | Shank Hardware |

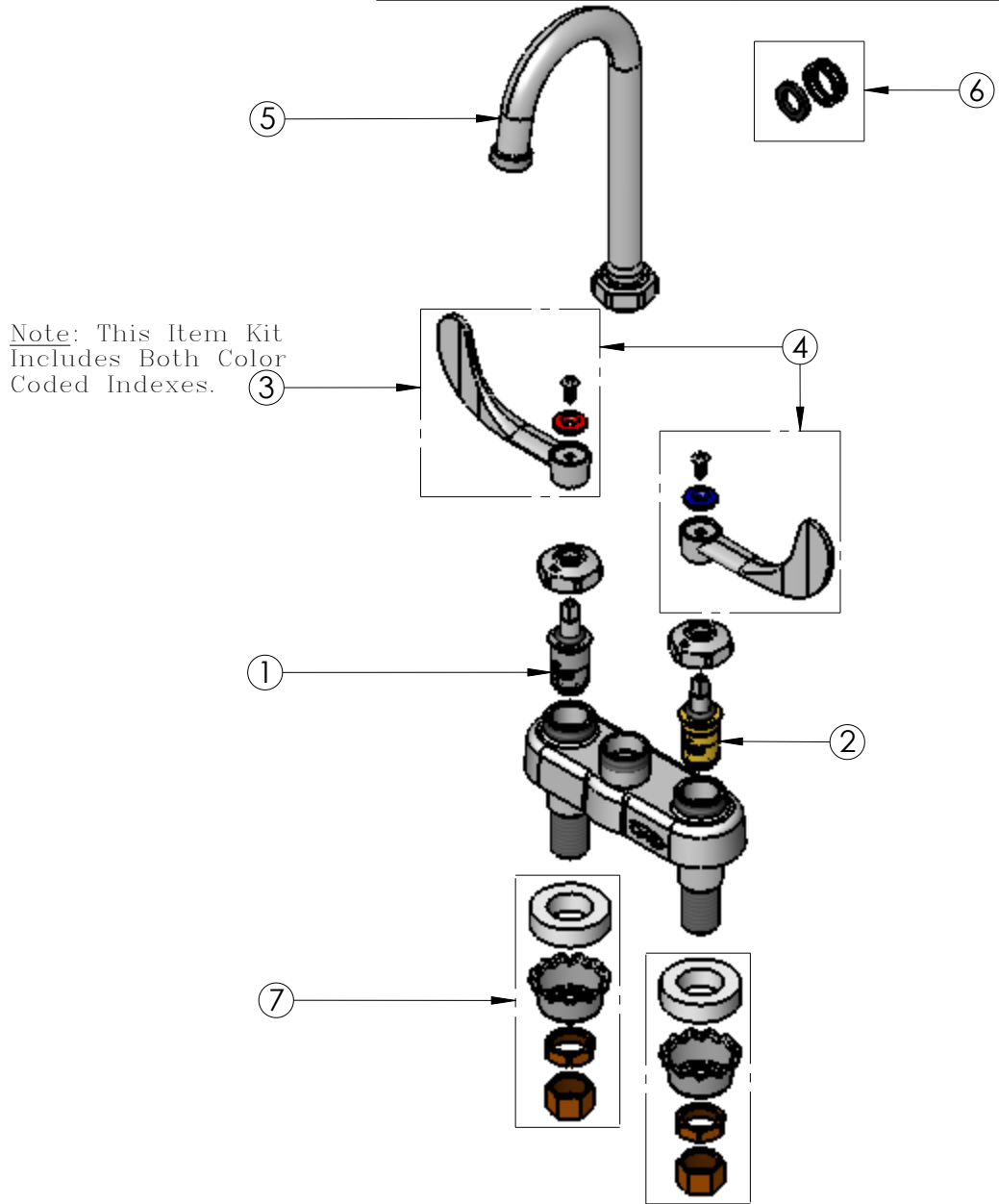

| | | | | | |
|----------------------------|-----------------|--------------|--------------|----------------|-----------------|
| Model Number Q-438WA-5W | Date 8/14/06 | Scale 1:4 | Drawn DHL | Checked JRM | Approved JHB |
|----------------------------|-----------------|--------------|--------------|----------------|-----------------|

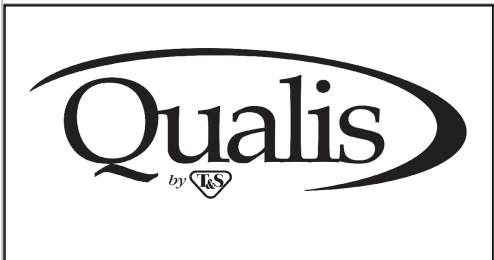

Product Specifications:
 4" Centerset Mixing Faucet, Ceramic Cartridges,
 Wrist Action Handles, 3 1/2" Gooseneck (GN-A),
 1.2 GPM Flow Control



T&S BRASS AND BRONZE WORKS, INC.
 2 Saddleback Cove, P.O. Box 1088
 Travelers Rest, South Carolina 29690
 Phone: 800.476.4103 Fax: 800.834.3518, Simi Valley 800.423.0750



REG. #A2601
 ISO #9001