

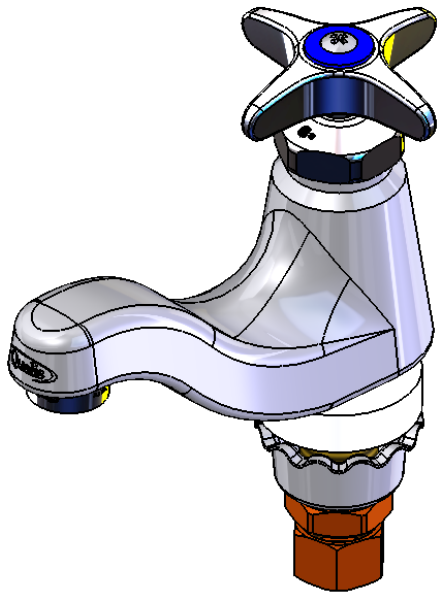

ADA COMPLIANT



This Space for Architect/Engineer Approval

Job Name \_\_\_\_\_ Date \_\_\_\_\_

Model Specified \_\_\_\_\_ Quantity \_\_\_\_\_

Customer/Wholesaler \_\_\_\_\_

Contractor \_\_\_\_\_

Architect/Engineer \_\_\_\_\_

Available Options

Model Suffix #	Description
<input type="checkbox"/> -5A	2.2 GPM VR Aerator
<input type="checkbox"/> -5B	0.5 GPM Aerator
<input type="checkbox"/> -5C	0.5 GPM VR Aerator
<input type="checkbox"/> -5D	2.2 GPM Laminar Flow
<input type="checkbox"/>	
<input type="checkbox"/> -VR5C	Complete VR Pkg (0.5 GPM)
<input type="checkbox"/> -VR5A	Complete VR Pkg (2.2 GPM)
<input type="checkbox"/>	

Ceramic Cartridge w/ 4-Arm Handle & Blue Color-Coded Index

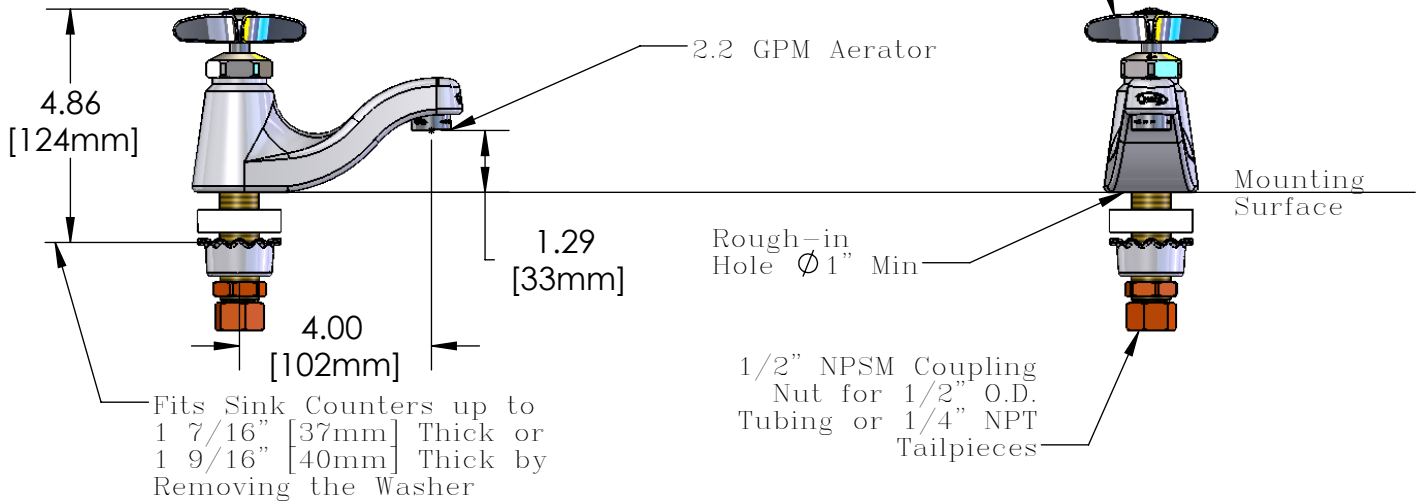

Model Number <b>Q-148UZ</b>	Date <b>04/04/08</b>	Scale <b>1:4</b>	Drawn <b>JRM</b>	Checked <b>GEF</b>	Approved <b>JHB</b>
--------------------------------	-------------------------	---------------------	---------------------	-----------------------	------------------------

Product Specifications:

**Basin Faucet,  
Ceramic Cartridge, 4-Arm Handle,  
& 2.2 GPM Aerator**



T&S BRASS AND BRONZE WORKS, INC.  
2 Saddleback Cove, P.O. Box 1088  
Travelers Rest, South Carolina 29690

Phone: 800.476.4103 Fax: 800.834.3518, Simi Valley 800.423.0750



REG. #A2601  
ISO #9001

ITEM NO.	SALES NO.	DESCRIPTION
1	Q017047-40	4-Arm Handle Kit
2	Q015383-40	Standard Ceramic Cartridge, Hot
3	Q014985-45	2.2 GPM Male Aerator
4	Q015424-40	Shank Hardware

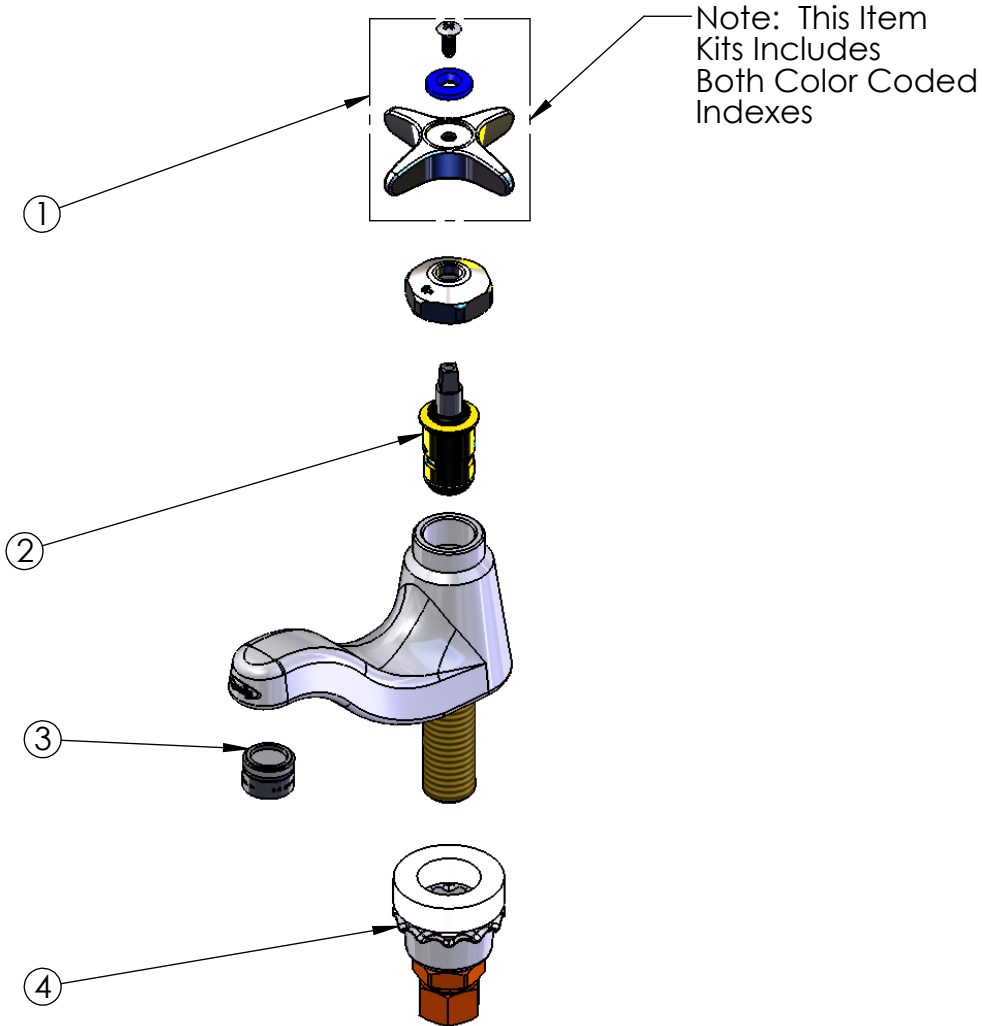

Model Number Q-148UZ	Date 04/04/08	Scale 1:4	Drawn JRM	Checked GEF	Approved JHB
-------------------------	------------------	--------------	--------------	----------------	-----------------



Product Specifications:

Basin Faucet,  
Ceramic Cartridge, 4-Arm Handle,  
& 2.2 GPM Aerator



T&S BRASS AND BRONZE WORKS, INC.  
2 Saddleback Cove, P.O. Box 1088  
Travelers Rest, South Carolina 29690  
Phone: 800.476.4103 Fax: 800.834.3518, Simi Valley 800.423.0750



REG. #A2601  
ISO #9001